

- LEGEND:**
- PERMANENT STOCKPROOF BOUNDARY
 - FENCING BOUNDARY
 - ROAD PAVEMENT
 - PASSING BAY VERGE
 - PASSING BAY PAVEMENT
 - PERMANENT LANDTAKE
 - TEMPORARY LANDTAKE

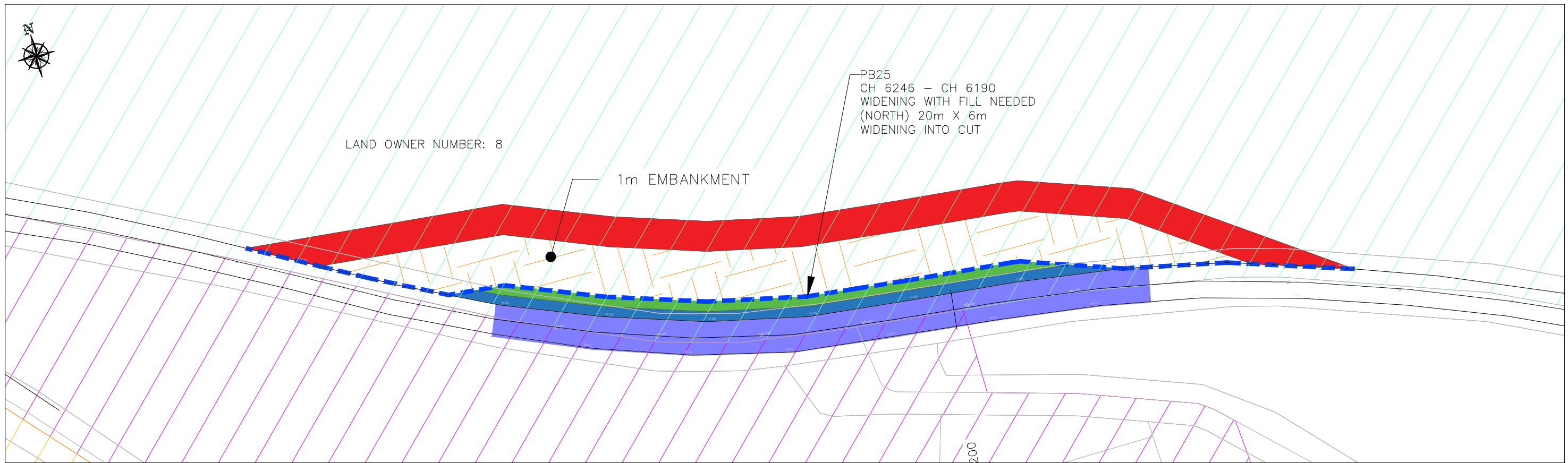

DURSEY ISLAND CABLE CAR & VISITOR CENTRE DEVELOPMENT

ENVIRONMENTAL IMPACT ASSESSMENT REPORT

STW
Scott Tallon Walker
ARCHITECTS

72 South Mall,
Cork,
T12 VX9A
t +353 (0)21 4320744
mail@stwarchitects.com
www.stwarchitects.com

Architects and Urban Designers

PROD
ROUGHAN & O'DONOVAN

Arena House, Arena
Road, Sandylford,
Dublin 18, Ireland
t +353 (0) 1 294 0800
f +353 (0) 1 294 0820
www.rod.ie

Consulting Engineers
Civil - Structural - Transportation - Environmental

Project Stage	E.I.A.R.				
Project Title	Durse Island Cable Car & Visitor Centre Development				
Drawing Title	Figure 4.18 Proposed Passing Bays Along Approach Road Sheet 06 of 10				
Drawing Number	Project	Originator	Volume	Location	Type Role Number
	DCCVC	ROD	HGN	SW_AE	DR - CH - 4.18
Scale (A1) 1:200 (A1) 1:400 (A3)	Date:	MAR 2019	Job No:	18.148	Rev: -